

OKAI

The manufacturer reserves the right to change and release product firmware updates and to keep this manual up to date.
<https://www.okai.co>

OKAI Beetle

EA10 Series

Instruction Manual

Contents

1.Introduction	02
1-1.Technical Data	03
1-2.Symbol Explanations	05
1-3.List of finished product and parts	06
2.Intended Use	07
3.Safety Instructions	08
3-1.General safety instructions	08
3-2.Battery safety precautions	11
3-3. Safety instructions for battery charger	11
4.How To Use	12
4-1.Using the product for the first time	12
4-2.Charging the battery	24
4-3.Ride preparation	24
5.Maintenance,Cleaning and Service	25
5-1.Maintain	25
5-2.Clean	25
5-3.Storage and transportation	25
6.Handling	26
7.Explanation Of Error Codes	26

1.Introduction

Thank you for purchasing the OKAI electric scooter.

OKAI sincerely hopes that you can ride the scooter safely and enjoy a comfortable riding experience. Since riding a scooter carries certain risks, please read this practical manual carefully before riding, and adequately prepare before going on the road. Please keep the instruction manual in case you need it from time to time. If you give the electric scooter to others, please also provide them with this user manual. Failure to comply with this user manual may cause serious injury to people or cause damage to the product. OKAI does not assume any responsibility for this. In order to be concise and easy to read, the OKAI E-Scooter will be referred to as “product” in the following Content.

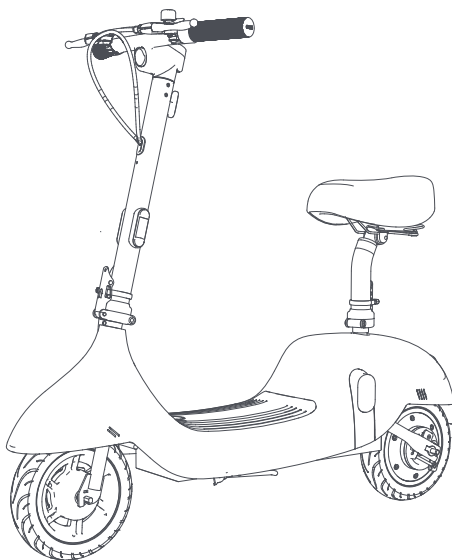

1-1.Technical Data













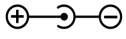

Item	Content	EA10A	EA10C
Vehicle Specifications	Dimensions (unfolded): LxWxH	1145*533*1045mm	1145*533*1045mm
	Dimensions (folded): LxWxH	1145*554 *614mm	1145*554 *614mm
	Wheel Base	882mm	882mm
	N.W.	28kg	29kg
	Max Speed	25km/h / 15mph	25km/h / 15mph
	*Range	≤40Km	≤55Km
	Max Gradient	20%	20%
	Power consumption per hundred of kilometer	0.94 kW·h/100km	0.9 kW·h/100km
	Adapted Terrain	Pavement	Pavement
	Operating Temperature	0~40°C	0~40°C
	Storage Temperature	-20~50°C	-20~50°C
	Undervoltage Protection	33V	39V
	Overcurrent Protection	22A	22A
	IP Rating	Finished product IPX5	Finished product IPX5
Charging Time	2A<6h;3A<4h	2A<6h;3A<4h	
Battery Specifications	Battery Type	Li-ion Battery	Li-ion Battery
	Rated Voltage	36V	47V
	Max Charging Current	5A	5A
	Rated Capacity	10.4Ah (10 series 4 parallel)	10.4Ah (13 series 4 parallel)
	BMS	Negative point port	Negative point port
	Battery Quantity	40Pcs	52Pcs
	Swappable Battery? (Yes or No)	Yes	Yes
	Charging Cabinet Version	/	/
Motor Specifications	Motor Size	10inch	10inch
	Max Torque	23N.m	28N.m
	Rated Voltage	36V	48V

Item	Content	EA10A	EA10C
	Rated Power	350W	350W
	Max Power	750W	900W
	Rated Speed	530±15 r/min	530±15 r/min
	Motor Control Mode	Brushless gearless motor	Brushless gearless motor
Brake	Braking Distance	<4.5m	<4.5m
	Brake Type	The front wheel is equipped with a mechanical drum brake The rear wheel is equipped with a mechanical drum brake+ electronic brake	The front wheel is equipped with a mechanical drum brake The rear wheel is equipped with a mechanical drum brake+ electronic brake
Tire	Tire Size	Front:10inch Rear:10inch	Front:10inch Rear:10inch
	Tire Material	Vacuum tires	Vacuum tires
Charger	Input Voltage	100-240V	100-240V
	Output Voltage	42V	54.6V
	Output Current	2A	2A
User	Minimum Load	40kg	40kg
	Max Load	100kg	100kg
	AGE Recommended	>14 years old	>14 years old
	Height Required	120-200cm	120-200cm
Characteristics	Brake Light	Light off/low light flashing alternately	Light off/low light flashing alternately
	Riding Mode	Zero start (Rear drive)	Zero start (Rear drive)
	Certification	FCC,UL testing report	FCC,UL Certification
Bluetooth	Frequency Band	2.4000-2.4835GHz	2.4000-2.4835GHz
	Max Frequency Band Power	20mW	20mW
Packing	Manner Of Packing	1pc/ctn	1pc/ctn
	G.W.	32.5kg	33.5kg

*Endurance: When fully charged, with a load of 75kg, an ambient temperature of 25°C, driving on a flat road at a constant speed of 60% of the maximum speed.

*Factors affecting battery life include: speed, ambient temperature, climbing, number of starts and stops, etc.

1-2.Symbol Explanations

 DANGER	Indicates a hazard signal with a high degree of danger. If not avoided, death or serious injury may occur.
 WARNING	A hazard signal that indicates a moderate hazard. If not avoided, death or serious injury may occur.
 CAUTION	A hazard signal that indicates a lower hazard. If not avoided, mild or moderate injury may occur.
	This symbol marks additional information and instructions about the product and its use.
	This symbol stands for "conforms to EU standards", meaning "conforms to" EU Directive. The manufacturer makes a ce mark to confirm that the product complies with applicable European directives and regulations.
	Please read the instruction manual carefully before use.
	Positive and negative display.
	This product is a second-class protection product.
	This product can only be used by people weighing more than 40 kg and less than 100 kg.
	Wear personal protective equipment(PPE).
	The product can only be used by one person at a time.
	It can only be used on flat and dry roads.
	Please do not use this product after taking alcohol, sedatives or psychotropic drugs.
	Minimum age: 14 years old.
	Do not enter the road with these signs.

1-3. List of finished product and parts

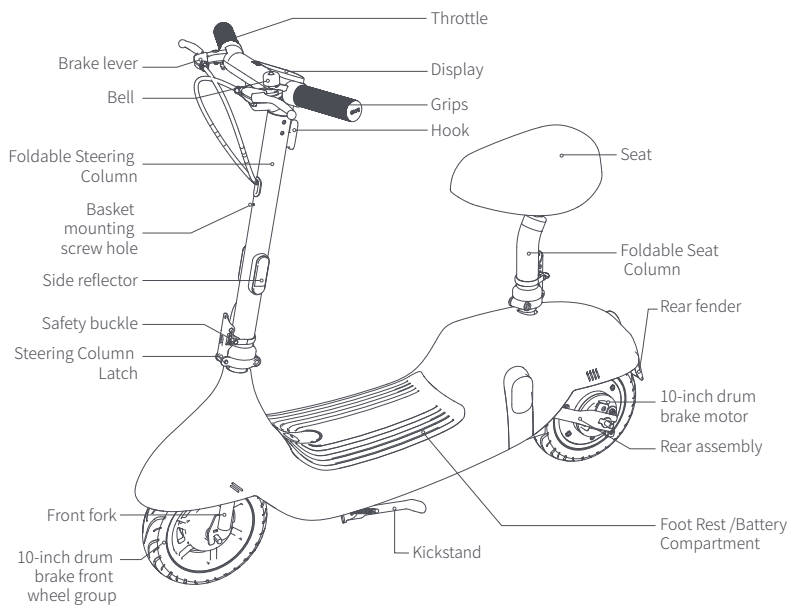

EA10A/EA10C

Size: length 1145*width 533*height 1045mm

2.Intended Use

·An electric scooter is intended for sport and entertainment purposes, not for use as a means of transportation, but the transportation function of the product once you drive it into public areas (as permitted by the laws and regulations of your region and country)also carries potential safety risks for all vehicles. Drive strictly in accordance with the instructions in this manual to ensure the safety of yourself and others to the utmost extent, and to ensure compliance with national first-level traffic laws and regulations of various provinces and cities, such as traffic regulations, etc.

·Please note: Once you drive an electric scooter on public roads or other public places (as permitted by the laws and regulations of your region and country regarding the use of electric scooters on public roads or other public places), even if you fully comply with this safe driving guide operation, you may also face risks caused by illegal driving/improper operation by others, or other vehicles. Just like when walking or riding a bicycle, you may also be injured by other vehicles. As with any vehicle, the faster you drive an electric scooter, the longer the distance required to brake, and emergency braking on smooth surfaces may also cause the wheels to slip and lose balance or even fall over. Therefore, it is very important to be vigilant when driving, maintain a proper speed, and maintain a reasonable and safe distance from other people and vehicles. When driving on unfamiliar terrain, stay alert and drive at a low speed.

·Please respect the pedestrian's right of way when driving. Avoid frightening pedestrians, especially children.

·When driving in countries and regions where there are currently no national standards and regulations related to electric scooters, such as China, please be sure to comply with the safety requirements for drivers in this manual. Zhejiang Okai Vehicle Co., Ltd will not bear any direct or joint liabilities for any financial losses, losses of life, legal disputes, or any other unfavorable events that occur due to the violation of the recommended uses indicated in this manual.

·To avoid potential injury, do not lend the electric scooter to people who can't operate it. If you give the electric scooter to a friend to use, please be responsible for your friend's safety, teach them to operate the scooter, and tell them to wear protective equipment.

·Please perform a basic inspection of the electric scooter before each driving. If you find that there are loose parts, the battery life is obviously reduced, the tires are excessively worn, the steering makes abnormal noises or malfunctions, etc., please stop using the scooter immediately, and do not force it to drive.

3.Safety instructions

This section lists the safety instructions that should be followed when using this product

3-1 General safety instructions

It may be dangerous to use this product! Learn to use the product step by step and spend enough time in practicing. Please follow all the tips and warnings set forth in this manual to reduce risk of injury. Even if you have enough practice, guidance or expertise, you may still lose control, collide or fall over, which may cause serious harm to yourself or others.

1. Keep the printed instructions for further reference and read carefully before use.
2. Maximum speed allowed: 25 km/h (15 mph).
3. Pregnant women, the disabled, and those who suffer from heart, head, back or neck conditions (or have undergone operations on these parts) should not use this product.
4. Do not use this product after taking alcohol, sedatives or psychoactive drugs.
5. Keep a distance of at least 1m/3ft from pedestrians, other vehicles and any obstacles.
6. This product can only be used when the environment permits it and the personal safety of bystanders is guaranteed.
7. Pay attention to the obstacles in front and of those far away.
8. This product may be used by only one person. It is forbidden to use this product with others. Don't make sharp turns when driving the scooter at high speeds.
9. Avoid sudden acceleration or sudden braking; do not lean your body for acceleration.
10. Excessive forward or backward is strictly prohibited.
11. Do not misuse this product. Do not use this product on roadsides, ramps, in skate parks, empty swimming pools, or any place similar to sliding plates.
12. Do not use this product to cross obstacles, slopes, ice or snow, nor climb up or down steep slopes, stairs or escalators. Do not expose this product in the rain.
13. Do not use this product in places where the depth of the puddle exceeds 2cm / 0.76in, because water may enter the motor.
14. Don't jump on this product. Don't try to use this product to do any acrobatics or activities not intended.
15. In order to avoid distraction when riding, please do not wear earphones, earplugs, make or answer calls, take pictures or videos or do any activities that are not related to riding so that you may maintain an awareness of your surroundings at all times.
16. Be sure to hold both handles when riding.
17. Avoid using this product at night or in places with poor visibility.
18. When you encounter pedestrians or other obstacles, check if you can pass safely.
19. Please use this product and its accessories at an appropriate temperature. Pay attention to the temperature requirements for battery charging.

20. Please always wear personal protective equipment (to protect wrists, knees, head and elbows) suitable for your weight and size to avoid injury. In working areas, local laws or regulations may have minimum requirements for helmets. In addition, it is suggested that safety mirrors be worn.
21. According to French traffic rules, reflective clothing and helmet is strongly required when riding.
22. Do not hang this product with other products or vehicles.
23. When not used, this product should be parked with the kickstand.
24. Any load added to the handle will affect the stability of the scooter.
25. **WARNING!** The braking distance will be extended under humid conditions.
26. **WARNING!** If any mechanical parts are subject to great external pressure and wear, different materials and parts may react differently. If a part exceeds the expected service life, it may suddenly break, which may cause injury. Cracks, scratches and discoloration in the area affected by external pressure indicate that the part has exceeded its service life and should be replaced as soon as possible.
27. **WARNING!** Please keep the plastic cover away from children to avoid suffocation.
28. Please spend enough time practicing how to use this product, so as to avoid accidents caused by lack of skills.
29. If training is required, the seller may provide corresponding training tutorials
30. When you are approaching pedestrians or cyclists, you may ring the bell to alert them.
31. When passing a protected passage, please dismount from the scooter and walk through it.
32. Pay attention to protect your own safety and the safety of others in all cases.
33. Do not use this product for other purposes such as carrying people and objects.
34. Using the brake for long durations may cause it to heat up. Avoid touching them to prevent burns.
35. Regularly check all bolts and screws, especially the axles, folding system, steering system and brake shaft.
36. It is prohibited to refit this product, including steering tubes, steering sleeves, steering rods, folding mechanisms and rear brakes.
37. Accessories and any additional items which are not approved by the manufacturer shall not be used.
38. When riding, the noise should not exceed 70dB.
39. When using the product, users must wear shoes.
40. This appliance can be used by children aged from 14 years and above and persons with reduced physical, sensory or mental capabilities or lack of experience and knowledge if they have been given supervision or instruction concerning use of the appliance in a safe way and understand the hazards involved. Children shall not play with the appliance. Cleaning and user maintenance shall not be made by children without supervision.

41. Traffic in the city has many obstacles to cross such as curbs or steps. It is recommended to avoid obstacle jumps. It is important to anticipate and adapt your trajectory and speed to those of a pedestrian before crossing these obstacles. It is also recommended to get out of the vehicle when these obstacles become dangerous due to their shape, height or slippage.
42. Get closer to your seller so he can refer you to an appropriate training organization.
43. Avoid high traffic areas or overcrowded areas.
44. In any case, anticipate your trajectory and your speed while respecting the code of the road, the code of the sidewalk and the most vulnerable.
45. Notify your presence when approaching a pedestrian or cyclist when you are not seen or heard.
46. Cross the protected passages while walking.
47. In all cases, take care of yourself and others.
48. Power-off the vehicle during charging.
49. Do not divert the use of the vehicle.
50. This vehicle is not intended for acrobatic use.
51. Caution, the brake may become hot in use. Do not touch after use.
52. Regularly check the tightening of the various bolted elements, in particular the wheel axles, the folding system, the steering system and the brake shaft.
53. Eliminate any sharp edges caused by use.
54. Do not modify or transform the vehicle, including the steering tube and sleeve, stem, folding mechanism and rear brake.
55. The self-tightening nuts as well as the other self-tightening fastenings may lose their efficiency and that they may need to be retightened.
56. **WARNING!** As with any mechanical component, a vehicle is subject to high stresses and wear. The various materials and components may react differently to wear or fatigue. If the expected service life for a component has been exceeded, it may break suddenly, therefore risking causing injuries to the user. Cracks, scratches and discoloration in the areas subject to high stresses indicate that the component has exceeded its service life and should be replaced.
57. In order to prevent theft, it is recommended that physical lock be used when the scooter is not in use to secure it.
58. **WARNING!** Risk of Fire and Electric Shock – No User Serviceable Parts.
59. **AVERTISSEMENT !** Risque d'incendie et d'électrocution – Aucune pièce réparable par l'utilisateur.
60. Prolonged exposure to UV rays, rain and the elements may damage the enclosure materials, store indoors when not in use.

Failure to use common sense and heed the above warnings will increase the risk of serious injury or even death, so be careful!

3-2 Battery safety precautions

- The battery should not be exposed to excessive heat such as sunlight, fire or the like. Otherwise there will be a risk of explosion!
- If this product is not used for more than 30 days, please fully charge the battery.
- Fully charge the battery every 90 days. Otherwise, the battery will conduct self-discharge and be damaged.
- If the battery emits a strong smell or becomes hot, stop using the product immediately. Do not open the product casing and don't try to disassemble the battery by yourself.
- Please dispose of the battery correctly and safely.

3-3 Safety instructions for battery charger

- Please use the original battery charger provided with the product for charging.
- The battery charger is not suitable for children under 14 years old, people with mental disorders, those who are disabled, etc., unless they use this product under the supervision or guidance of their guardians.
- Check again whether the power plug and cable are damaged. If so, they must be replaced by the manufacturer, a designated service agent or a person with similar qualifications to avoid danger.
- Before cleaning, storage and transportation, disconnect the battery charger from the power source and allow it to cool down.
- Protect electrical components from moisture. When the battery charger is cleaned or used, do not immerse it in water or other liquids to avoid electric shock. Do not put the battery charger in water. When being charged, this product must be placed in a well-ventilated place. After the battery is fully charged, immediately disconnect the charger from the power source.
- Regularly check whether the battery charger is damaged. A damaged battery charger must be repaired before use. Do not use a battery charger that has been left exposed for a long time or damaged.
- Do not connect a damaged product to the battery charger. There is a risk of electric shock!
- Do not disassemble the battery charger. Repairs must be performed by reliable after-sales service personnel. Incorrect assembly may cause fire or electric shock.
- Do not use the charger near flammable and explosive items, otherwise there is a risk of fire and explosion.
- Please check the technical data before connecting the battery charger to the power source. Improper use may cause fire! The battery charger should be used indoors only.
- Do not misuse the battery charger. The battery charger is only suitable for this product. Use with other products may cause fire or electric shock.
- Make sure that the battery charger and the charging port are properly connected and not blocked by foreign objects.

- Keep the charging port clean, dry, and free from dust and humidity. Do not put any objects on the battery charger, and don't cover it. Otherwise, the battery may overheat. Do not place the battery charger near any heat sources.
- Be sure to place the power line in places where no one may trip, step on, or damage it. Otherwise there will be a risk of material damage and personal injury.
- Do not disconnect the battery charger from the power source by pulling the power line. Please manually remove the plug.
- Do not attempt to charge non-rechargeable batteries.

4.How to use

4-1 Using the product for the first time

This section provides information on how to use the product correctly. To ensure user safety and service life, it is important to follow these instructions.

- 1.Open the package, take out the accessories box and the foam in the middle slot.

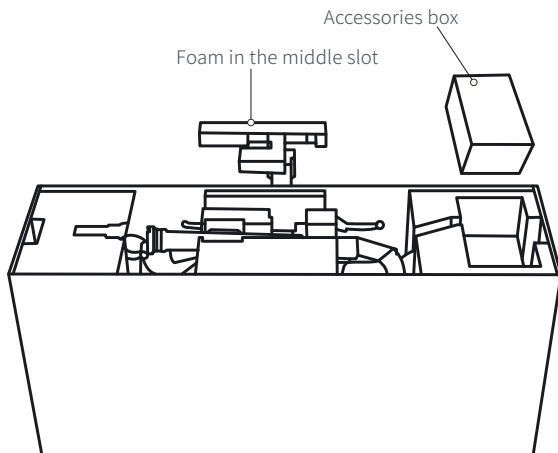

2. Remove the head tube and steering tube from the foam. Lift the steering tube up a bit and insert the head tube into the steering tube. Lift the preinstalled head module into an upright position. Use the hexagon wrench tool to tighten the head tube with four M6 screws.

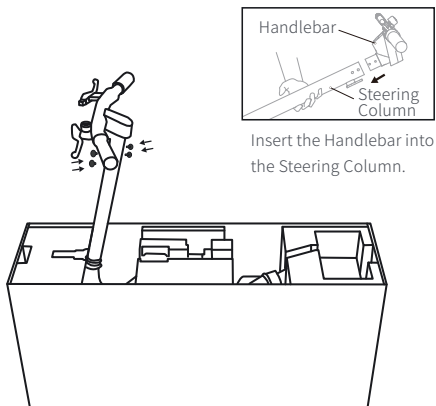

3. Remove the top three foam.

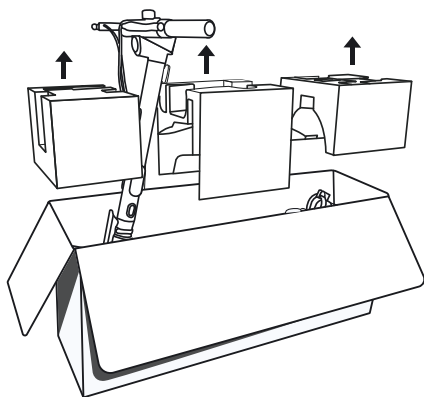

4. Steering Column installation procedures.

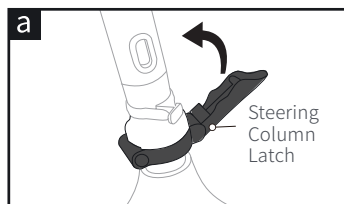

Stand up the Steering Column and pull the Steering Column Latch upward to secure it.

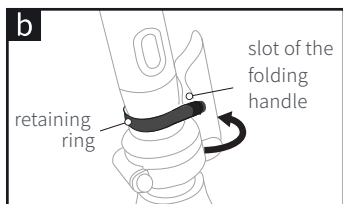

Clamp the retaining ring into the slot of the Steering Column Latch, to serve as a secondary level of safety.

5. Seating Column installation procedures.

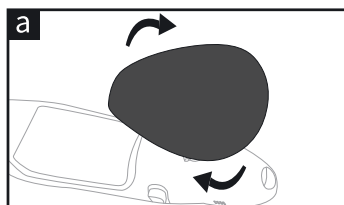

Stand up the Seating Column and secure it down with the Seating Column Latch.

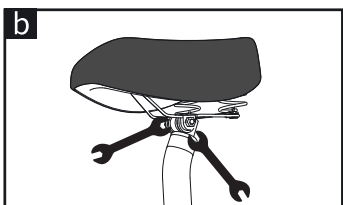

Insert the seat cushion into the seat tube retaining groove, and align the body with a wrench to tighten the seat screws.

6. Get the vehicle out of package.

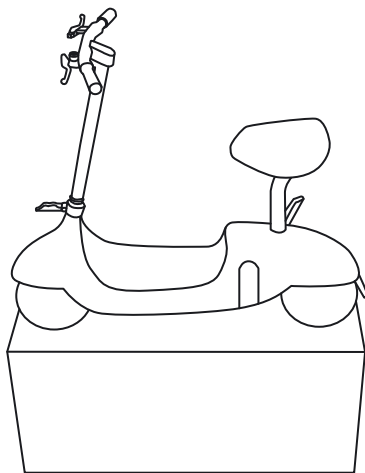

7. Use the key to open the pedal cover and connect the battery plug to power up the vehicle;
Open the front charging port cover on the right side of the vehicle and connect the charger to charge the vehicle.

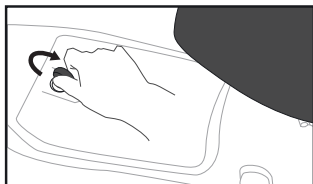

Use the key to open the battery pedal.

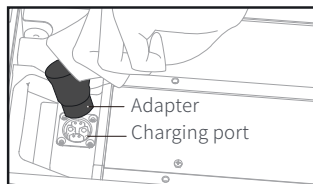

Insert the adapter into the charging port on the battery.

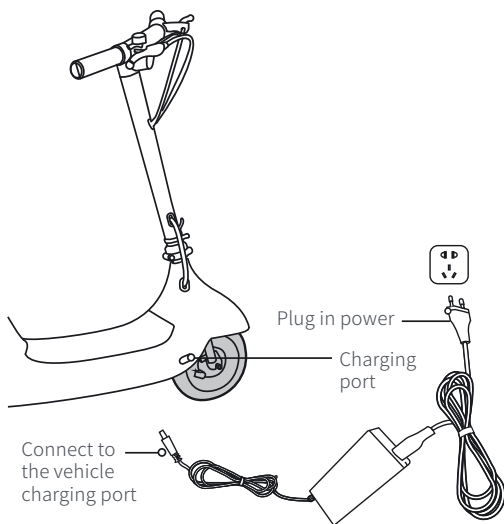

⚠ Note: For first use, please connect the charger to activate vehicle.

8. Use the key LOGO surface to touch the meter, or touch the LOGO surface of the key to turn on the meter, or press the unlock button on the key to enter P mode. Press the left handlebar button to enter cycling mode.



9.Remote key (With NFC function): Touch the LOGO surface of the key to turn on the meter, or click the unlock button on the key to turn it on to enter the P mode, and click the function button on the left handlebar to enter riding mode.

Function button (left button of hand handle) : After the vehicle is started into P mode, press to enter riding mode,press and hold the function button for about 3 seconds to power off;

Press the function button once to turn the headlights on/off while the vehicle is powered on;

Press twice to switch to E (pedestrian mode) /L (economy mode) /H (sports mode) while the vehicle is powered on;

E mode is pedestrian mode, with a maximum speed of 5km/h (3mph), which is suitable for use on pavement when pedestrians are around;

L mode is economy mode,with a maximum speed of 15km/h (9mph);

H mode is sports mode, with a maximum speed of 25km/h (15mph);

Press five times in riding mode to switch the speed unit;

APP turns on the cruise function, which maintains a constant speed.

When the vehicle speed is greater than 5km/h (3mph), press and hold the function button for 2 seconds to enter cruise mode.

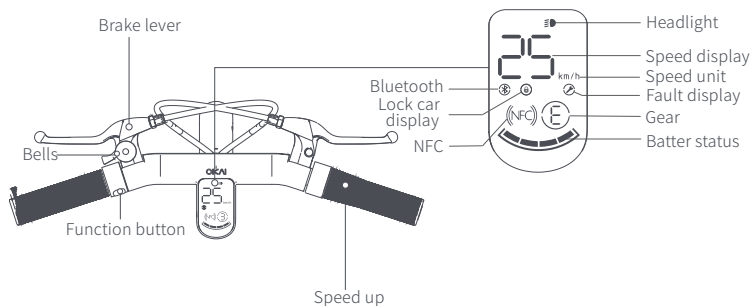

10. Wear a helmet and protective gear.

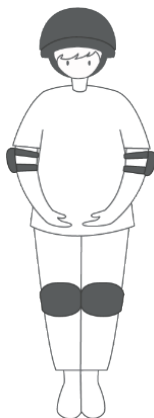

11. Please check the vehicle before each use.

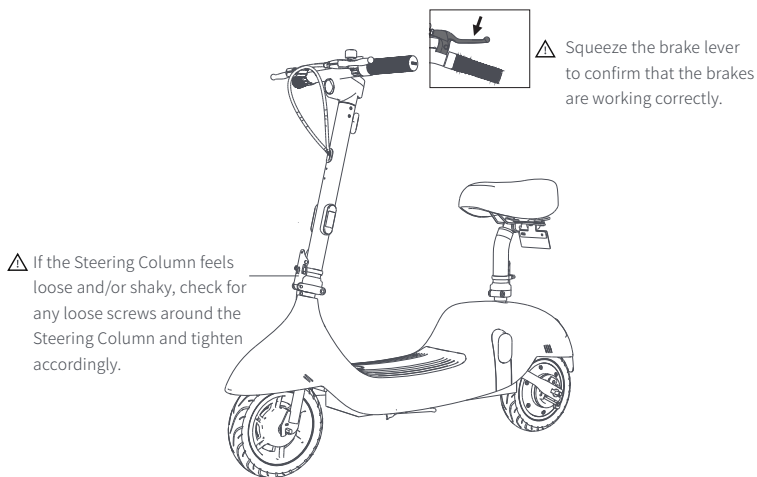

12. Twist the throttle to accelerate

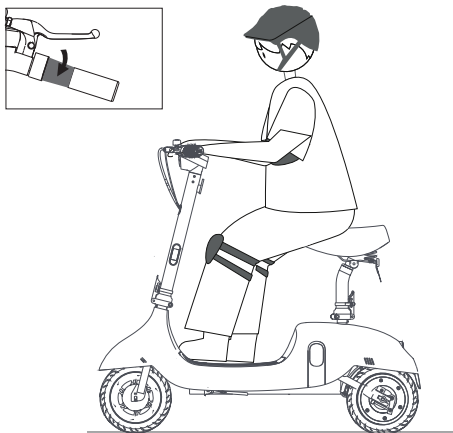

13. Release the acceleration handle to reduce speed, and squeeze the brake lever to brake.

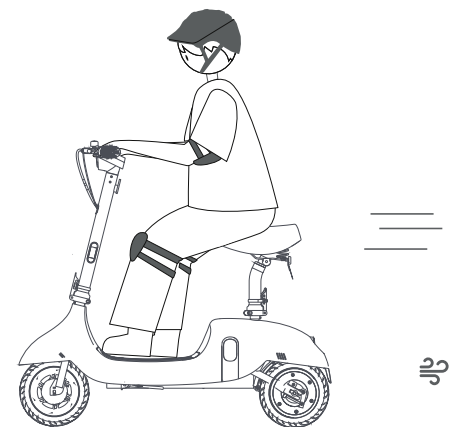

14. To change the center of gravity when turning, turn the handle slightly.

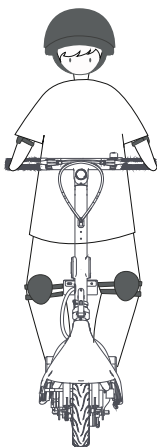

15. When you need to stop, release the accelerator and squeeze brakes on the handlebar. Lay down the kickstand and let the vehicle lean slightly onto the kickstand to allow the scooter to stay upright.

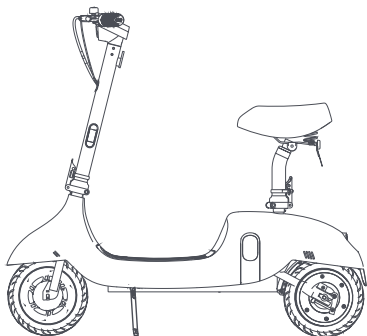

16.safety warning

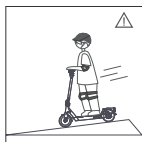

Pay attention to the speed when riding downhill.



Watch out for your head.

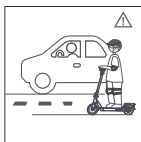

Pay attention to other vehicles on the road.

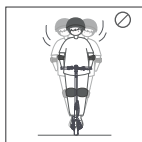

Do not shake.



Do not use your mobile phone.



Do not ride the electric scooter on rainy days.



Do not use the electric scooter to carry people.



Always keep your hands on the handlebars.

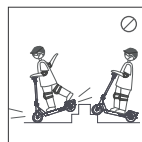

Do not cross large gaps or steps.



Do not step on the fender.



Do not press the throttle when pushing the electric scooter.



Do not stand on the scooter with one leg.



Do not put heavy items on the electric scooter.

17.Folding operation

①Separate the fixing ring from the folding handle;

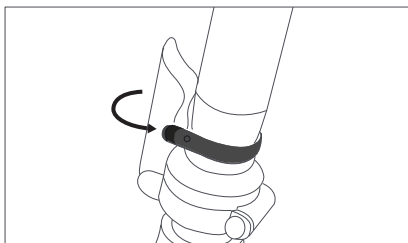

- ② Move the Steering Column down so that the pole can be folded down, and hold the Steering Column with your hand to prevent it from falling;

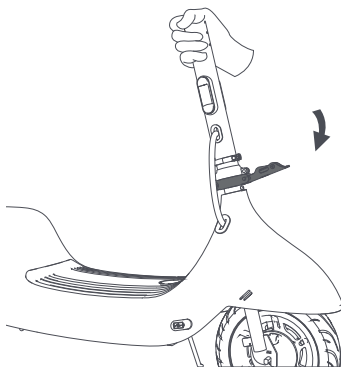

- ③ Put down the Steering Column and complete the folding.
(To fold the Seating Column, repeat the process)

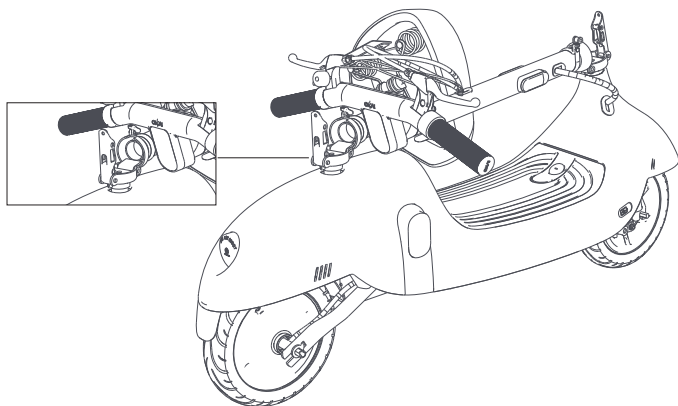

18. Activate the app

Please scan the QR code to download the app (the system version and Bluetooth version are subject to the actual requirements of the app). You can find the cruise control function in the app, and discover more ways to use the scooter.



① Install APP, please register/login

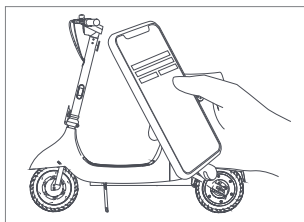

② Open the app, click "Search for Device". Follow the app prompt to pair with and connect to the scooter.

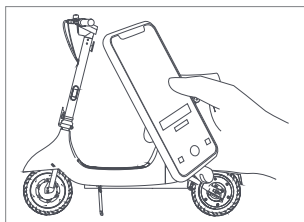

③ Watch the driving guide

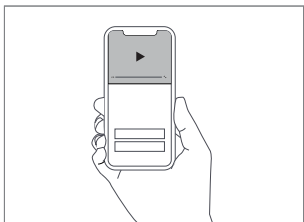

④ Start exploring a new riding experience

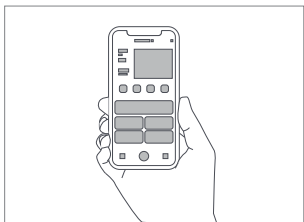

Now, you can use your scooter, check the status and detect the ride through the app.

4-2 Charging the battery

- Charging port

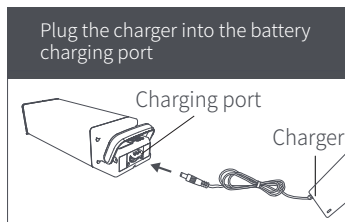

Figure 1

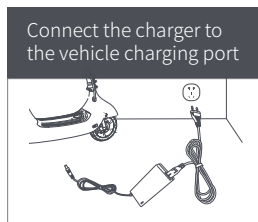

Figure 2

After taking the battery out of the frame, plug charger into the battery charging port (as in Method 1), or directly connect the charger to the vehicle charging port (as in Method 2).

4-3 Ride preparation

Checklist:

- Wheels - check that the wheels are not damaged or excessively worn.
- Loose parts - make sure that all parts, such as nuts, bolts and fasteners are safe. Parts should not make any abnormal sounds.
- Operating area - make sure that the operating area is open and flat without any obstacles.
- Laws and requirements - check and comply with any local laws or regulations. When using this product on public roads, comply with local laws and regulations.
- Safety equipment - always wear personal protective equipment (wrist, knee, head and elbow protection). In some areas, local laws or regulations may require helmets.

⚠ WARNING :Do not ride with the product using one hand. Don't try to perform any stunts or tricks while riding.

⚠ WARNING :Driving at a medium speed will increase mileage. When driving at high speed for a long time, frequently starting, stopping and idling, as well as frequent acceleration and deceleration will reduce mileage.

5.Maintenance,Cleaning and Service

5-1.Maintain

Please follow the maintenance SOP provided by our company for the maintenance of this product and its accessories. If you have any questions or problems, please contact our company.

5-2.Clean

- Please turn off this product before cleaning.
- Before each cleaning, unplug the battery charger from the power source and unplug the charging cable from the product.
- Never use solvents or abrasive cleaners. Never use stiff brushes, metal or sharp objects when cleaning. Solvents are harmful and can damage plastics; abrasive cleaners can scratch the surface.
- Clean the battery charger and product with a slightly damp cloth. Afterwards, wipe all parts with a dry cloth.

⚠ WARNING :Do not immerse the product or battery charger in water or other liquids. Do not place the product or battery charger under running water. Doing so creates a risk of electric shock!

⚠ WARNING :This product cannot be cleaned using a power washer.

5-3.Storage and transportation

- Store the product in a dry, clean place, out of the reach of children, preferably in the original packaging.
- During transportation, turn off the product.
- The product can only be shipped in its original packaging. Don't throw away the packaging because shipping the product may be required in the future. Protect the product during transport (for example, using bungee straps) to prevent it from falling or tipping over to protect the product from impact and vibration, especially when being transported on a vehicle.

⚠ WARNING :This product contains a built-in lithium battery. Lithium-ion batteries are considered dangerous goods to be transported, and may only be transported when permitted by local laws and regulations.

⚠ WARNING :If you plan to travel by plane or other means of transportation with your product, please check with your transportation company whether product transportation is feasible.

6.Handling



This mark indicates that this product should not be disposed of with other household waste. In order to prevent possible harm to the environment or human health caused by uncontrolled waste disposal, it is our responsibility to recycle this product to promote the sustainable reuse of material resources. To dispose of the used product, please contact the recycling system or contact the retailer of the product. They can recycle this product environmentally and safely.



Dispose of batteries in accordance with environmental protection requirements. Do not throw away the battery with daily garbage. Contact the recycling system in your community, or contact the retailer where you purchased the product.



Packaging materials can be transported back to the raw material circulation. Dispose of packaging materials in accordance with legal regulations. Relevant information can be obtained from the recycling system in your community.

7.Explanation of error codes

Error number	Error name	The reason	Troubleshooting method
01E	Overcurrent protection	The instantaneous output current of the controller exceeds the current limit range(>25A)	The controller output current is less than 25A and then recovers
02E	Undervoltage protection	When the battery voltage is lower than $30 \pm 1V$	1. The fault is resolved automatically after charging 2. Replace the battery
03E	Motor phase line failure	Short circuit of motor phase line when unlocking	1. Replace the motor 2. Replace the controller
04E	Locked-rotor protection	The motor is blocked or short-circuited, or the drive is faulty	1. Release the locked-rotor state 2. Replace the motor
05E	The upper MOS tube is damaged	The drive upper bridge MOS tube is damaged or broken down	Replace the controller
06E	Damaged lower MOS tube	The driving lower bridge MOS tube is damaged or broken down	Replace the controller
07E	Motor Hall failure	The hall wiring sequence is wrong or the connection is bad	1. The plug-in connection is bad, reconnect it 2. Replace the motor

Error number	Error name	The reason	Troubleshooting method
08E	Motor overheated	Motor temperature exceeds the normal operating temperature	1. Stop riding and cool down, and wait for the fault to be resolved by itself 2. Replace the motor
09E	Lever failure	Handlebar malfunction or poor connection	1. Check the connection of the switch handle and eliminate the poor contact 2. Replace the handle
10E	Left brake failure	Left brake lever Hall failure or poor connection	1. Check the brake lever wiring to eliminate poor contact 2. Replace the left brake lever
11E	Instrument to electronic control central control failure	The instrument communication connector is faulty or the device is faulty	1. Check the wiring of the instrument and the central control harness plug-in of the instrument, and eliminate the poor contact 2. Replace the meter
12E	The meter receives data timeout failure	The instrument communication connector is bad or the device is bad	1. Check the wiring of the instrument and the central control harness plug-in of the instrument, and eliminate the poor contact 2. Replace the meter 3. Replace the controller
15E	Controller firmware is missing	The controller app program is damaged	1. Re-upgrade the controller program 2. Replace the controller
18E	Handlebar does not return	The handle turns back into position when turning on or the handle is damaged	1. Put the transfer back into place 2. Replace the handle 3. Release the handle
19E	Left brake lever is not reset	The left brake does not return or the left brake is damaged when starting up	1. Return the left brake lever 1. Replace the left brake
20E	Right brake lever has not returned	The right brake is not in position when turned on or the right brake is damaged	1. Return the right brake lever 2. Replace the right brake